

# Video Doorbell V8

---

Please read the instructions thoroughly before using your doorbell. This booklet contains important information that will allow you to utilize the full potential of your doorbell.

## In the box

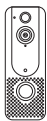

Video Doorbell



USB Cable



2 Anchors



2 Screws



User Manual



2 Batteries  
(Optional)



Chime  
(Optional)



3M Tape

## Know your device

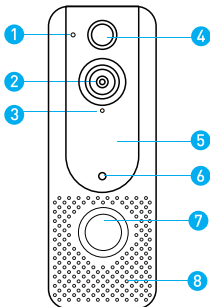

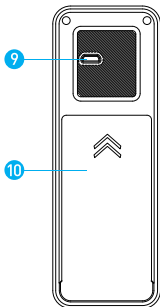

1. Microphone
2. Wide-angle Lens
3. Indicator Light
4. Motion Sensor
5. Hidden Infrared Lights



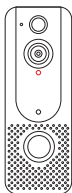

6. Light Sensor
7. Doorbell Button
8. Speaker
9. Micro USB Port  
(Battery Charging)
10. Battery Slot

## Indicator Light



 RED Indicator light flashes:  
The device is connecting to your Wi-Fi, please wait.

 RED and BLUE indicator lights flash alternately:

 Low battery, please charge your batteries.

## Charge batteries

1. Remove the battery tab.

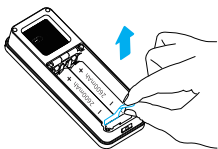

2. Insert batteries with the correct polarity

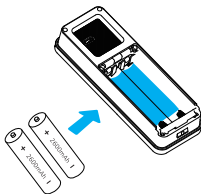

Rechargeable 18650 Battery

3. Charge the batteries with a USB cable. A full charge takes about 8 hours.

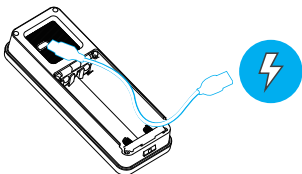

# Set up your Video Doorbell

## Step 1

Scan the QR codes below, or search for “Aiwit” on the Apple app store or Google Play. Download and install the App.



Aiwit



Android / iOS  
App Download

\*\*\* To make sure every single feature works properly, please select “YES” for all permissions on your phone during the APP installation.

## Step 2

Open the Aiwit App on your cellphone. Next, tap Sign up.

## Step 3

Enter your email that will link with the doorbell and the password, then tap “Sign up”

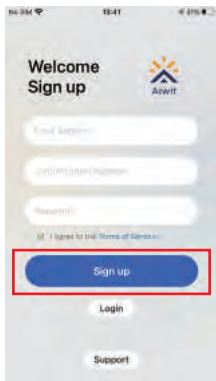
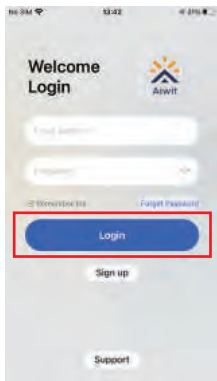

#### Step 4

You will receive an email with the confirmation code. Please enter the code and tap “Confirm”.

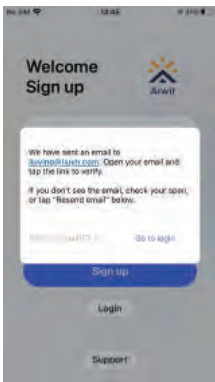

#### Step 5

Enter your email and password, then tap “Log in”.

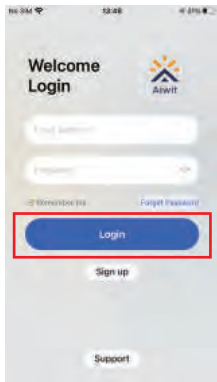

#### Step 6

Tap the “+” icon

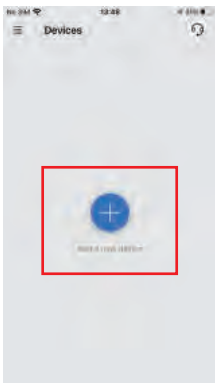

#### Step 7

Select “Video Doorbell”



## Step 8

Press and hold the button located on the front of the doorbell for 8 seconds until the indicator light is flashing red. Then, tap “Next”.



## Step 9

Tap “Yes”.



## Step 10

Find your Wi-Fi (Some phones need to input manually) and enter the Wi-Fi password, then Tap “Next”.



## Step 11

Scan the QR code with your doorbell camera. Keep the cellphone and doorbell 10 to 30cm apart.



## Step 12

If the doorbell connected with your Wi-Fi successfully, a notification will appear on your screen as shown below. If it fails to connect with your Wi-Fi, please repeat steps 8 to 11.



## Step 13

After setup, you will be able to check the live footage on your screen, and operate the doorbell with your cellphone.



If you experience some issues during the app setup, try the following steps:

Check your Wi-Fi password.

The most common issue during setup is an incorrect Wi-Fi password, passwords are case-sensitive. Please double check your password.

Reboot the router/modem.

If you have entered the correct password, but are still experiencing issues, try unplugging the power to your router/modem. Wait for 30 seconds, then plug it back in and turn it on. Proceed to setup again in the Aiwit app.

# Install your Video Doorbell

When finding a place for your doorbell, please be sure that your doorbell does NOT directly face the sunlight, which may cause inaccurate notifications.

If installing on a masonry surface, drill holes first with a drill bit, then insert the wall anchors prior to screwing your doorbell base.

If installing on a wooden surface, you can screw the base directly into the surface.

## Step 1

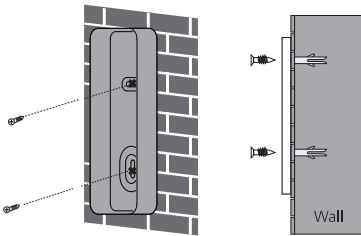

## Step 2

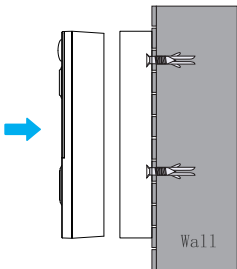

If the surface is smooth enough, you can stick the doorbell to the surface by using the 3M tape that comes in the box.



# Trouble Shooting/ FAQ' s

Q1. How do I enable notifications on my phone?

Go to the Aiwit app, then tap the “settings” icon, turn “Motion Alerts” on.

\* \*To get the notification, you need to give the Aiwit app permissions to access your phone. If your Aiwit app does not have permissions, you need to do this first. Steps may vary for different devices. Generally, they are as indicated:

Step 1: Open “Settings” on your phone. Go to “App & Notifications”.

Step 2: Go to “App permissions”. Make sure all options are enabled.



Q2. How to adjust Motion Detection Sensitivity?

From the home page, tap the “Motion Detection” icon, then go to the “Motion Settings”.

Sensitivity settings decide when and how often your doorbell wakes up and starts to record. Settings range from “High” to “Off”.

High: Records and notifies you for almost every movement, the detection scope is around 7 meters. Which means all the movements within this area will be detected, and the doorbell will wake up and start to record a video.

Medium: Records and notifies less often.

Low: Records and notifies you even less often.

The detection scope is around 1.5 meters.

Off: Does not notify nor record.

\*\*Choosing a high sensitivity setting will decrease battery life. Under this setting, you will get the shortest battery life and frequent notifications. Under a constant state of activity, it may result in the battery running out fast.

A low sensitivity setting will make the battery last longer. Under this setting, you will get longer battery life and less amount of notifications.

You should try all the setting first, and then choose whichever seems more fitting.



Q3. How can I talk to people through the doorbell?  
Open you Aiwit App, active the doorbell. Hold the “Hold to talk” button to talk.

The intercom can go both ways, but only 1 person can talk at a time. When the button on your phone is held, sound from the doorbell will not be delivered to your phone. When the button on your phone is released, your voice will not be delivered to the doorbell.

\*\*To get the intercom, you need to give the Aiwit app permissions to access your microphone and speaker. If your Aiwit app does not have permissions, you need to do this first by following the steps in Q1.

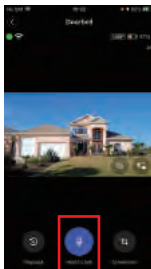

Q4. How long do my videos stay in my cloud storage?

Your videos are stored in the Free Cloud for 3 days. After 3 days, your old videos will be replaced by the new ones.

If you want a longer storage span, you can buy the extension on the App. The steps are as below.

Step1. Go to the main menu, tap the “Settings” button.

Step2. Go to the bottom, choose the “Cloud Storage Service”

Step3. Select one of the options that you need.

Q5. What is the maximum time of one video?

A)For motion detection

After a movement is detected, the doorbell starts to record videos. Each video will last 15 seconds. After a recording is finished, a new video will be generated automatically. The doorbell will go to sleep when no more movements are detected.

B)For live view

When you check the live footage, a video up to 3 minutes long will be generated and be uploaded to the cloud. The recording will end in 3 minutes. If you want to record a longer footage, you need to re-enter the doorbell after 3 minutes. Then the doorbell will record for another 3 minutes.

Q6. If the battery runs out, do I need to reconnect the doorbell with Wi-Fi manually after charging?

No, the doorbell will automatically connect to your Wi-Fi once the power is back.

When the power first comes back, the doorbell will search for your Wi-Fi once every 10 minutes. If it does not find the Wi-Fi in the first hour, the doorbell will reduce the search down to once every 2 hours until it connects with your internet. So please be patient once the power is back.

Q7. How do I share the device with my family

Open the Aiwit app. From the home page, tap the “Share” icon. Tap “Share via Email” or “Share via QR Code”. You can share the device with up to 8 users.

Share via Email:

The new user needs to download the Aiwit app and create an account with the email address which the owner has shared with. Log into the account and you will see the shared device.

Share via QR Code:

Open the Aiwit App on a new user’s phone.

From the home page, tap the “+” icon.

Tap QR Code Sharing, then scan the QR code on the owner’s phone.

You should see Share successfully being displayed, then tap Confirm.

\*\*The secondary users do not have the following permissions as the main user: set the sensitivity, change the device account, delete the videos from the cloud, or share the device with new users.

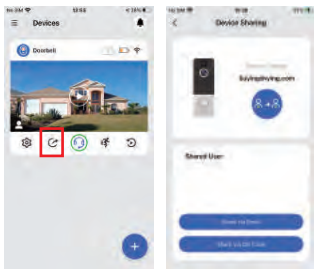

Q8. How many users can view the footage at the same time? Up to 3 users may view the footage at the same time, but only 1 user can use the direct intercom. Both IOS and Android are compatible.

Q9. Why does my device often go offline?

Your device may be too far away from your wireless router or you may have some obstructions in between that reduce signal strength. You may need to try repositioning your router or getting a signal extender/repeater for your wireless router.

Q10. How long can a battery last after being fully charged?

Generally, the battery can last around 1200 notifications. Different temperatures can make the battery life vary.

Q11. Why does my battery die extremely quickly?

A) Your device may be too far away from your wireless router or you may have some obstructions in between that reduce signal strength. Your device keeps on finding and reconnecting with the signal, which drains the battery. You may need to try repositioning your router or getting a signal extender/repeater for your wireless router.

B) You may have forgotten to exit from your Aiwit app after a live view.

If you don't exit from your app after a live view, the doorbell will stay on, which drains the battery.

C) If you set the the sensitivity at the “High” on your app, frequent wake-ups can drain the battery.

Q12. Why does my phone not get a notification when someone presses the button?

It is likely that your phone battery is optimized, you can set the battery option to “Don’t optimize” for your Aiwit App.

Steps may vary for different devices. Generally, they are as indicated:

Step1.Go to the “Settings” menu.

Step2.Select “Battery optimization”, then find the Aiwit app.

Step3.Select the app, then choose “Don’t optimize”

Q13. Why does my cellphone get a delayed notification?

If this happens when your phone is connected with your Wi-Fi router, either your Wi-Fi signal is weak, or your internet is slow.

You may need to try repositioning your router or getting a signal extender/repeater for your wireless router.

If this only happens when you are using some sort of mobile internet connection, you may need to check with your internet provider.

Q14. Why do I get inaccurate notifications sometimes?/ I received a notification, but there is nothing at my door?

Your doorbell might be facing the sunlight directly, or there may be some kind of obstruction in front of it. Any sort of moment will trigger your doorbell, even shadows originating from objects such as clouds or leaves.

Q15. How to RESET network settings

Press and hold the doorbell button until the red light is flashing, then follow the in-app instructions to finish your Wi-Fi setup.

Q16. What type of Micro SD card should I use?

This device comes with cloud storage, so no SD card is needed.

Q17. Does this doorbell support 5GHz Wi-Fi?

No, only 2.4GHz Wi-Fi is supported.

## Set up the chime (Optional)

With the doorbell chime, you can get an instant notification in your home whenever someone rings the doorbell. You can place it anywhere in your home by plugging it into a power outlet. A chime is optional. Even if it's not installed, you cellphone can still receive doorbell notifications.

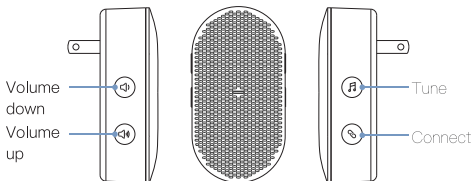

### Step 1

Before the setup, please be sure your doorbell has connected to your phone and your chime has plugged into a outlet.

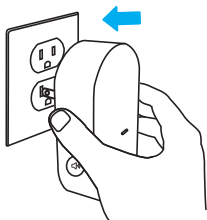
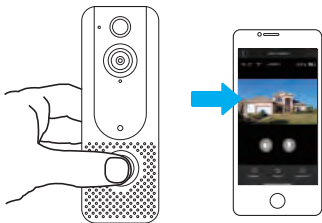

## Step 2

Press the Connect Button.



## Step 3

Press the Doorbell Button to pair your doorbell with the chime.

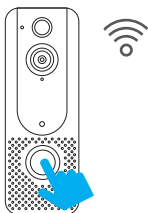

## Step 4

Press the Tune Button to choose a tune.

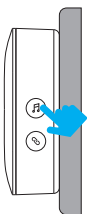

## Step 5

Press the Doorbell Button again to make sure it's the tune you have chosen.

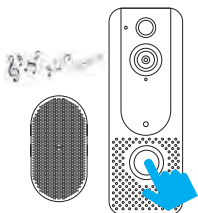

## Warranty and after-sale service

This video doorbell is under a 2-year warranty. Should you have any questions or problems during use, please feel free to let us know. You can write to us at

[VANBAR-Service@outlook.com](mailto:VANBAR-Service@outlook.com)

We will reply ASAP.