

B3

Quick Installation Guide

Wire-Free Battery-Powered 1080P
Home Security Camera

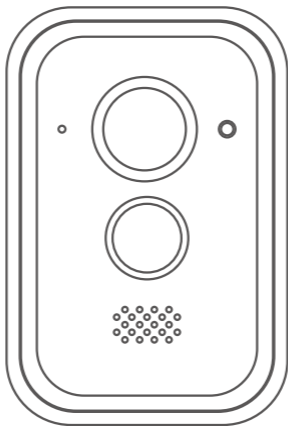

What's in the Box



Battery
Camera

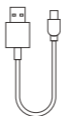

Power
Cable

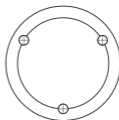

Punch positioning
sticker



Installation
Guide



Base

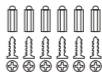

Mounting Screws
& Anchors

Product Diagram

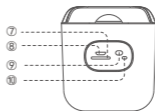
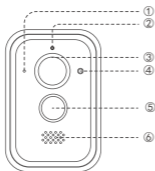

- | | | | |
|----------------|-------------------|---------------------|-------------------|
| ① Microphone | ② Indicator light | ③ Night vision LED | ④ Photoresistance |
| ⑤ P I R sensor | ⑥ Speaker | ⑦ MicroSD Card Slot | ⑧ Micro USB port |
| ⑨ Reset button | ⑩ Switch button | | |

INDICATOR LIGHTS STATUS

Light Status	Camera Status
Red light on	Camera is powered on
Red and blue light flashing alternately	Waiting to connect Wi-Fi
Blue light flashing	Camera is connecting Wi-Fi
Blue light solid	Succeed to connect Wi-Fi
Red light flashing quickly	<ol style="list-style-type: none">1. Reset camera to factory setting2. Camera is upgrading firmware

Button Controls

Button	Function	Operation Manual
RST	enter into the network configuration status	Press and hold the RST button 3-4S, the device will play a beep sound, release the button, the red and blue lights flash alternately
	reset	Press and hold the button for about 8s, the device will play the prompt sound of "DiDi", the red light will flash quickly, and the device will sleep after 2S
switch ON/OFF button	switch ON	Press and hold the button for about 2S, the device will play "power on music"
	switch OFF	Press and hold the button for about 3S, the device plays "shutdown music"

Install the camera

1. Power the camera

The camera has a built-in 18650 battery pack. It is recommended to use a 5V 1A adapter to charge the battery.

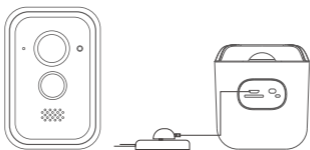

2 Installation diagram

- Mount the battery camera on the wall
- Install the battery camera on the desktop or shelf

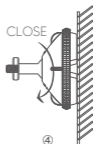
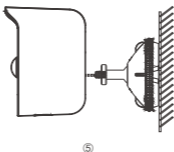
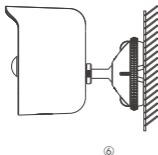
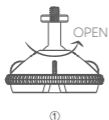

Precautions

Please pay attention to the power supply specifications if you want to use another adapter to charge the camera.

- please pay attention to the working temperature range.
- Do not use in environments with strong electromagnetic interference or near corrosive substances.
- The warranty does not cover defects and damages caused by misuse, unauthorized dismantling, or natural hazards.
- Built-in 18650 battery pack, actual battery life results may vary depending on device settings, usage, and environmental factors.
- The PIR motion sensor can only detect motions within a certain range and will not be activated by motions out of the range.



User's Guide

1. Download and Install

Go to the App Store or Google Play to search and download "Wansview Cloud" APP on your smartphone. Or scan below QR code to get the APP.



2. Register Account

Open the "Wansview Cloud" APP and register an account with your email, and activate it.

Tips: Your password must be 8-16 characters, and contains at least the following three categories: numbers, uppercase letters, lowercase letters or special characters.

3. Add Battery Camera



①

Click "Add Device" or "+"



②

Select Battery camera



③

Device Power ON



④

Pairing-Mode



⑤

Wi-Fi setup



⑥

Scan the QR code



⑦

Wait for connection



⑧

Pair succeed

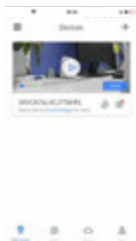

⑨

The device is online



⑩

Live video

Tips:

1. This battery camera only works with 2.4GHz Wi-Fi, 5GHz Wi-Fi is not supported!
2. Please put the camera near to the router during setting up the camera, after connecting the camera to Wi-Fi, you can place the camera to other place.

Advanced Features



Cloud storage: After enabling cloud storage, alarm records could be automatically saved on the cloud server without data loss or corruption.



Motion detection: With built-in PIR sensor, it supports to capture moving objects and automatically trigger 10s short alarm recordings and real-time push notifications.



Two-way intercom: while watching videos, you can talk to family members far away Online.



7/24 Monitoring: With built-in IR-CUT, it could achieve 7 days, 24 hours monitoring with a piece of mind.



Device sharing: As an administrator, you can share the devices bound to your account with your family and friends, and it can be revoked at any time.



Smart power-saving: We do the intelligent power-saving treatment on hardware and software. Support auto hibernation, when someone enters into the PIR detecting range, the machine will wake up automatically.



TF card storage: Insert a TF card(max 128GB, not included) you can record alarm video to the TF card without using Cloud storage.